

FUERHA DEENTRO







F U E R A
D E N T R O

FUERAD
DENTRO

FUERADENTRO

WWW.FUERADENTRO.COM

INFO@FUERADENTRO.COM

T +31 20 624 51 11

FUERADENTRO CATALOGUE CONTENTS

CIMA COLLECTION	6
CIMA LOUNGE COLLECTION	38
SHELL COLLECTION	54
PLANTERS	70

FUERADENTRO RESERVES THE RIGHT TO ADJUST OUR PRICES AND MODELS AT ANY TIME. COLOURS ARE NOT BINDING.

COPYRIGHT

ALL FUERADENTRO DESIGNS, NAMES, PHOTOS AND INTELLECTUAL PROPERTY USED IN THIS BROCHURE ARE THE COPYRIGHT OF FUERADENTRO. ANY INFRINGEMENT OR ABUSE OF OUR COPYRIGHT WILL BE PURSUED BY LAW. FUERADENTRO ALWAYS RESERVES THE RIGHT TO MAKE CHANGES OR ADDITIONS TO THE DESCRIPTIONS OR FEATURES GIVEN IN THIS BROCHURE IN THE LIGHT OF TECHNICAL DEVELOPMENTS OR AVAILABILITY OF MATERIALS. WE ARE NOT RESPONSIBLE FOR VARIATIONS IN COLOUR, WEIGHT OR DIMENSIONS, AS VARIATIONS ARE POSSIBLE WHENEVER PRODUCTS ARE HAND-MADE.

ALL FUERADENTRO DESIGNS ARE REGISTERED TRADEMARKS AND COPYRIGHTED BY FUERADENTRO. OUR TRADEMARK IS PROTECTED BY LAW AND ALL INFRINGEMENTS AGAINST OUR TRADEMARK AND OUR COPYRIGHT WILL BE PURSUED BY LAW.

CIMA COLLECTION

The Cima collection, created by Dutch designer Hendrik Steenbakkers, is a complete collection of well designed, striking and minimalist garden and patio furniture. This series of contemporary furniture fully reflects the philosophy of FueraDentro. Each piece is designed to complement one another and looks stunning by the pool, on the patio or indoors. This comfortable and stylish outdoor designer furniture range includes dining chairs, dining tables, benches, lounge furniture, salon and side tables, high bar tables, bar stools and sun loungers. Complementing planters add the finishing touch to create an unique outdoor living space.

The pieces are created to be timeless in terms of quality, functionality, color and aesthetics and will come into its own in both contemporary and classical environments whether it is outdoors or indoors. The thin, but robust looking, stainless steel frames with

rounded corners, hold the seated area of the chairs and sunbeds in suspension, thus creating light and inviting furniture that is truly relaxing and enjoyable. The seats are made of Batyline mesh fabric which guarantees optimal comfort, a lasting high tension and an excellent resistance to tearing and UV-rays. Batyline, produced by world leader Ferrari, consists of woven polyester fibre protected by a PVC coating and is resistant to mould and mildew.





SIESTA SUNBED

7

SILLÓN CHAIR

Contemporary garden chair

Part of the Cima Collection, an extensive range of modern design garden furniture, the Sillon designer dining chairs are pure, minimalist and architectural in design and available in a range of contemporary colours. The thin high grade brushed stainless steel frame give these exterior/interior garden chairs an ultra-modern look and when used with a Doble or Nimio table, offer a stunning, minimalist outdoor dining solution.

Designed by Dutch designer Hendrik Steenbakkers, Cima outdoor furniture are built to a very high quality from the highest quality materials. Designed for life long

function, the materials exceed standards for durability and are suitable for all year round use, both indoors and out. The seat of the Poltrona is made of Batyline® fabric, which has a comfortable spring to it and is UV, mildew and stain resistant. The INOX elements to the furniture are optionally available in an electro polished finish. This provides optimum durability and resistance to even the harshest of marine environment.





NIMIO 260 & SILLÓN

9

BUTAQUE CHAIR

Contemporary dining chair for dining in style

Designed by Hendrik Steenbakkers, the Butaque dining chair is added to the FueraDentro outdoor furniture collection to create a bridge between the Cima Collection and the Lounge Collection. This way the dining area and lounge area can have a matching style.

The robust rectangular stainless steel frame of the Butaque designer chair holds the seated area, carried out in Batyline mesh fabric, in suspension. Due to the high back and the natural spring of the Batyline seat, this contemporary dining chair is also to be used without a cushion.

Effortless enjoyment can be enhanced with coordinating cushions in both fabric and synthetic leather, this allows the Butaque dining chair to be crafted to your own individual style and optimize your personal visual and physical ideals.

Create your favorite outdoor dining set

The high grade stainless steel frame, also available with an electro polished or powder coated finish, which give these indoor/outdoor chairs an ultra-modern look and when this minimalistic dining chair is used with a Doble or Nimio patio dining table, it offers an excellent contemporary dining solution. There is also a teak version of this modern garden dining chair available.

The Butaque dining chair is used by many hotels as restaurant chair for luxury patio furnishings.





BUTAQUE TEAK CHAIR

Teak designer garden chair for dining in a natural ambiance

A new addition to the Cima Collection, is the Butaque Teak dining chair. This exclusive outdoor dining chair is different than the Butaque chair. The frame of this teak version of this European designer chair is a little wider which gives it a more robust, but also a warmer look.

Teak is a strong wood which has the quality to withstand a great deal of wear and tear, as well as different temperatures and weather, even untreated. However, the best part of this material is its beauty. The natural, rich color, texture and quality of the wood are simply gorgeous.

The robust rectangular teak frame of the Butaque hardwood dining chair holds the

Cushions to complete the feeling of comfort and style

seated area in suspension. Due to the natural spring of the Batyline seat, the Butaque teak chair is also to be used without a cushion.

Coordinating cushions in both fabric and synthetic leather are available in several colors, which allows the Butaque teak chair to be crafted to your own individual style and optimize your personal visual and physical ideals.

The teak frame give these outdoor dining chairs an ultra-modern but warm look and when used with a Doble garden dining table, offer an excellent contemporary outdoor dining ambiance.







POLTRONA EASY CHAIR

Contemporary garden easy chair

The Poltrona garden easy chair is pure, minimalist and architectural in design and available in a range of contemporary colours. As all furniture in the Cima Collection, the high grade stainless steel frame give these interior exterior designer garden chairs an ultra-modern look, and optimum comfort is provided when used with the Escabel footstool for relaxing in luxury in your contemporary outdoor space. These patio furniture chairs are also often combined with the PoltronaTres garden sofa or the Pequena side table.

Designed by Dutch designer Hendrik Steenbakkers, Cima outdoor furniture are

built to a very high quality from the highest quality materials. Designed for life long function, the materials exceed standards for durability and are suitable for all year round use, both indoors and out. The seat of the Poltrona is made of Batyline® fabric, which has a comfortable spring to it and is UV, mildew and stain resistant. The INOX elements to the furniture are optionally available in an electro polished finish. This provides optimum durability and resistance to even the harshest of marine environment.







POLTRONA TRES SOFA

Contemporary garden sofa

This garden sofa is pure, minimalist and architectural in design and available in a range of contemporary colours. The high grade stainless steel frame give these interior exterior designer sofas an ultra-modern look, and optimum comfort is provided when used with the Escabel footstool for relaxing in luxury in your contemporary outdoor space. The Poltrona Tres sofa is often combined with the Poltrona garden easy chair or the Mesona salontable. highest quality materials. Designed for life long function, the materials exceed standards for durability and are suitable for all year round use, both indoors and out. The seat of the Poltrona is made of Batyline® fabric, which has a comfortable spring to it and is UV,

mildew and stain resistant. The INOX elements to the furniture are optionally available in an electro polished finish. This provides optimum durability and resistance to even the harshest of marine environment.

Designed by European designer Hendrik Steenbakkers, Cima garden chairs are built to a very high quality from the highest quality materials. The stainless steel elements to the furniture are optionally available in an electro polished finish and the seat of the Poltrona Tres is made of Batyline® fabric, which is UV, mildew and stain resistant and has a comfortable spring to it.





POLTRONA, MESONA 142 & PEQUEÑA



ESCABEL FOOTREST

Contemporary garden footstool

The Escabel footstool is designed to provide optimum comfort when used with the Poltrona garden easy chair or PoltronaTres garden sofa for relaxing in luxury in your contemporary outdoor space. As part of the Cima collection, an extensive range of clean and aesthetically pleasing modern design patio garden furniture, this garden footstool is pure, minimalist and architectural in design. The high grade stainless steel frame and Batyline® mesh fabric seat give this designer footrest an ultra-modern look.

Designed for life long function, the materials exceed standards for durability and are

suitable for all year round use, both indoors and out. Like all chairs in the Cima Collection, designed by Hendrik Steenbakkers, the seat is made of Batyline® fabric, which is UV, mildew and stain resistant and has a comfortable spring to it.

The stainless steel elements to the furniture are optionally available in an electro polished finish. This provides optimum durability and resistance to even the harshest of marine environments.







TUMBONA LOUNGER

Contemporary sun lounger

Designed by Dutch designer Hendrik Steenbakkers, Tumbona garden loungers are built to a very high quality from the highest quality materials. The lounge's posture is ergonomically designed, making it ideal for exceptionally comfortable dozing in the sun, as well as reading your favourite novel around the poolside. Cima Tumbona contemporary garden sunlounger is fitted with clear perspex and rubber wheels, enabling the lounge to be easily moved about, and with a cylindrical head cushion.

The seats, which are made of Batyline® fabric, have a comfortable spring to it and are

available in a range of contemporary colours. The fabric also has a memory, which returns it to its former position when you sit up out of the furniture and is UV, mildew and stain resistant. The high grade stainless steel frame, also available with an electro polished finish, gives these designer garden sunbeds an ultra-modern look and are an ideal choice when looking to relax in luxury in your contemporary outdoor space. The Tumbona sunlounger is often combined with the Pequena side table.







NIMIO BAR 190 & TABURETE

TABURETE BARSTOOL

Contemporary barstool

Part of the Cima Collection, an extensive range of modern design garden furniture, the Taburete designer barstool are pure, minimalist and architectural in design and available in a range of contemporary colours. The thin high grade brushed stainless steel frame give these exterior/interior garden chairs an ultra-modern look and when used with a Nimio bartable, offer a stunning, minimalist outdoor dining solution.

Designed by European designer Hendrik Steenbakkers, Cima patio furniture are

built to a very high quality from the highest quality materials, which exceed standards for durability and are great for entertaining family and friends all year round both indoors and outdoors. The seat of the Taburete outdoor barstool is made of Batyline® fabric, which is UV, mildew and stain resistant and has a comfortable spring to it. The stainless steel elements to the furniture are optionally available in an electro polished finish. This provides optimum durability and resistance to even the harshest of marine environments.







PEQUEÑA SIDE TABLE

Contemporary garden side table

Designed by Dutch designer Hendrik Steenbakkens, the Pequena side table is, as part of the Cima collection, pure, minimalist and architectural in design. The square table top, which seems to be floating on air in the stainless steel frame, is available in a Belgian bluestone, teak or matt coloured toughened glass version. The high grade stainless steel frame gives these garden indoor/outdoor tables an ultra-modern look and makes that these side tables are a great addition to any

contemporary outdoor space. The Pequena side tables are often used as stand alone objects or in combination with the Poltrona easy chair or Tumbona lounger.

The stainless steel elements to the furniture are optionally available in an electro polished finish. This provides optimum durability and resistance to even the harshest of marine environments.





MESONA SIDE TABLE

Contemporary garden side table

The Cima Mesona table, designed by Hendrik Steenbakkers, catches the eye by minimalist rectangular shape of the stainless steel base with rounded corners which holds the toughened glass or teak table top in suspension, seemingly floating on air. This contemporary design has a very spatial appearance.

Designed for life long function & outdoor chic, the materials exceed standards for durability

and resistance to the outdoor elements. The Mesona is often used in combination with the PoltronaTres sofa and Poltrona easy chair. The toughened matt glass is available in the colours black, white and cendre. For the stainless steel frame an electro-polished finish is optional.



NIMIO BAR 140 & 190 BAR TABLE

Contemporary garden bar tables

The design of the Nimio garden bar tables is modern, clean and aesthetically pleasing. The high grade stainless steel frame gives these garden outdoor bar tables an ultra-modern look. The table tops are available in Belgian bluestone, toughened matt glass in black or colored ceramic: white or cendre (sand). The Nimio tables are ideal for both modern and more traditional surroundings, due to the timeless simplicity of the architectural design. The Nimio bar tables are designed by Hendrik Steenbakkers and are often combined with Taburete bar chairs, which perfectly complement the design of the Nimio bar tables.

The stainless steel elements to the furniture are optionally available in an electro polished finish or powdercoated. This provides optimum durability and resistance to even the harshest of marine environments.





MACETERO 120, NIMIO BAR 190 & TABURETE

NIMIO TABLES TABLE

Contemporary garden dining and low tables

The design of the Nimio garden tables is modern, clean and aesthetically pleasing. The Nimio tables are available in square or rectangular (Nimio 200/260/325) formats and there's a low table version as well. The high grade stainless steel frame gives these garden indoor/outdoor tables an ultra-modern look. The table tops are available in Belgian bluestone, toughened matt glass in black or colored ceramic: white or cendre (sand). The Nimio tables are ideal for both modern and more traditional surroundings, due to the timeless simplicity of the architectural design. The Nimio tables are designed by Hendrik Steenbakkers and

are often combined with Sillon dining chairs, which perfectly complement the design of the Nimio tables.

The stainless steel elements to the furniture are optionally available in an electro polished finish or powdercoated. This provides optimum durability and resistance to even the harshest of marine environments.





DOBLE TABLE

Contemporary garden dining table

The diversity in materials offered within this range means the Doble table is the most adaptable to personal preferences of all tables in the Cima Collection. The table tops are available in Belgian bluestone, toughened matt glass in black or colored ceramic: white or cendre (sand). The Doble tables are ideal for both modern and more traditional surroundings, due to the timeless simplicity of the architectural design and when accompanied by either a Sillon or Butaque dining chair or atable is also available in the size 240, 270 & 300.

Designed by Dutch designer Hendrik Steenbakkers, these tables are built to a very high quality from the highest quality materials. Attention to detail in the design and production of the Cima range is outstanding; the adjustable stainless steel feet of the Doble table, and the etched FueraDentro logo on steel legs, are subtle yet highly attractive features in themselves. High grade stainless steel table base is also available in an electro-polished version or powdercoated.









DOBLE TEAK TABLE

Contemporary garden dining table

The diversity in materials offered within this range means the Doble TEAK table is the most adaptable to personal preferences of all tables in the Cima Collection. The table tops are available in teak. The Doble tables are ideal for both modern and more traditional surroundings, due to the timeless simplicity of the architectural design and when accompanied by either a Sillon or Butaque dining chair or Doble Bench, are an excellent contemporary dining solution. The Doble TEAK table is also available in the size 160, 180, 240, 270 & 300.

Designed by Dutch designer Hendrik Steenbakkers, these tables are built to a very high quality from the highest quality materials. Attention to detail in the design and production of the Cima range is outstanding; the adjustable stainless steel feet of the Doble TEAK table, and the etched FueraDentro logo on steel legs, are subtle yet highly attractive features in themselves. High grade stainless steel table base is also available in an electro-polished version and powdercoater.







DOBLE BENCH 240

DOBLE BENCH TABLE

Contemporary garden bench

To perfectly match the Doble tables, these outdoor garden benches are available in different sizes and the seat of the Doble Bench comes in a teak or a Batyline® version. Although the Doble Bench is original designed to be combined with the Doble table, this contemporary garden bench also looks great as a standalone object. For even more comfort a range of Stamskin® or acrylic cushions are available in matching colours.

As part of the Cima Collection and designed by European designer Hendrik Steenbakkers, the Cima Doble Benches are built to a very high quality from the highest quality materials. Attention to detail in the design and production of the Cima range is outstanding; the adjustable stainless steel feet of the Doble Bench, and the etched FueraDentro logo on steel legs, are subtle yet highly attractive features in themselves.





FUERA
DENTRO



DOBLE BENCH 240 TEAK



CIMA LOUNGE COLLECTION

The Cima Lounge collection, designed by Hendrik Steenbakkers, is a range of modular outdoor lounge furniture, which is pure lounge-style in a contemporary design. The most notable characteristics of the Lounge collection are the minimalistic design, the rectangular shape of the frames with the seemingly floating seating and table tops in between the frames.

FueraDentro has expanded this range of designer patio lounge furniture with new models, materials and options to further enhance the possibility to create an outdoor lounging area that fits your personal preferences. It innovates challenges and stays true to the designers vision. The Lounge Collection is more than just style, it's a contemporary statement.

All materials used for this designer garden furniture are high quality and exceed standards for durability and resistance to the outdoor elements. For the tables, available in five different sizes, the frame options are the same as for seat modules. The table tops for these outdoor designer tables are available in toughened glass, ceramic or teak. In all settings the minimalist lines and slim design with a focus on extreme comfort remain preserved.

With all the different options in material and colors for the modular components this contemporary designer outdoor furniture collection is fully adjustable to your personal style and preferences. The optional upholstery for the Lounge collection provide superlative comfort to this luxurious garden furniture range and give you the opportunity to further personalize your lounging area. In total you can choose between four different styles of cushions which will give the outdoor furnishings a unique appearance. The coordinating cushions are carried out in both Stamskin synthetic leather or 100% solution dyed acrylic fabric (Tempotest® or Sunbrella®).

An innovative design and a dedication to comfort ensure that every patio furniture design feels as good as it looks and is an invitation for a cosy get-together and a real eye-catcher on the terrace or in the house.



DOBLE 180, BUTAQUE, DOBLE BENCH & POLTRONA LOUNGE



POLTRONA LOUNGE
40

POLTRONA LOUNGE EASY CHAIR

Contemporary outdoor lounge chair

The Poltrona Lounge, designed by Hendrik Steenbakkers, catches the eye by its minimalist design. The most striking characteristic of this luxury outdoor lounge chair is the rectangular shape of the armrests, holding the seat in suspension. The appearance of this modern lounge chair is very spatial and pure and is minimalist and architectural in design. The Batyline seat of the Poltrona Lounge is ergonomically and slightly tilted to the back and is available in three basic colors.

Being part of the Lounge collection modular system the armrest are exchangeable. One can choose between a stainless steel, powder coated stainless steel or teak version. The armrests with a powder coated finish are available in the same colors as the seats.

Contemporary lounging in style

The optional cushions for the designer chairs and sofas are available in different styles which make it possible to adapt this designer lounge furniture to fit your personal preferences and give it an unique appearance. A tempting lounge chair with teak armrests and big, comfortable cushions or a modern stainless steel lounge chair which reminiscences to the Barcelona Chair by Mies van der Rohe, it will be a real eye-catcher on the patio or in the house. The cushions for this luxury outdoor furniture range are developed to provide superlative comfort and can be enjoyed all year round in many contemporary outdoor spaces.

The simple clean lines of the Lounge Collection make this a timeless modern design. The stainless steel elements to the furniture are optionally available in an electro polished finish. This provides optimum durability and resistance to even the harshest of marine environments.





POLTRONA LOUNGE & TABLA 150 LOUNGE



BANCA LOUNGE SOFA

Luxurious outdoor lounge sofa

This deluxe sofa, designed by Dutch designer Hendrik Steenbakkers, is part of the Lounge Collection and is pure, minimalist and architectural in design. The rectangular armrests of the Banca Lounge hold the Batyline seat in suspension, which give this designer outdoor sofa an airy look. In contrary to most other outdoor lounge sofas, which have a horizontal seat, the seating of the Banca Lounge is ergonomically and slightly tilted to the back. One can comfortably spend hours in this luxurious outdoor lounge furniture in relaxation and enjoy the surroundings of the garden or terrace.

To enhance comfort a range of cushions are available in regular acrylic fabric, or alternatively Stamskin, which is a synthetic leather, designed for year-round exterior use. One can choose between cushion that match the minimalistic design of this designer outdoor furniture and cushions that have a softer and warmer feel. The 'cozy' style cushions made of Tempotest fabric are standard available in four colors.

Extendable designer lounge sofa

To allow the outdoor lounge area to be created even further to your own personal style the modular armrests are available in a stainless steel, a powder coated stainless steel or teak version. Part of this modular Lounge collection is the Lounge Connector. This stainless steel connector allows the seat elements (single or double seat) to be connected to create a seating area with a length that suits your needs. There is no limit to the number of seat elements one can connect, which makes this contemporary lounge sofa also very suitable for use in public spaces.





BANCA LOUNGE, POLTRONA LOUNGE & MESITA

PIECERA 78 & 130 LOUNGE FOOTREST

A contemporary footrest for lounging in style

The Piecera Lounge footstool is to provide optimum comfort when used in any arrangement of our comprehensive outdoor Lounge collection. This luxurious footrest creates a perfect setting for relaxing in luxury in your contemporary outdoor space. It is minimalist and architectural in design and available in two sizes, the standard size Piecera 78 Lounge and the extra-large version Piecera 130 Lounge.

The Piecera Lounge can be used as footrest as part of a deluxe patio lounge set, but also as a stand-alone pouf in any of the modular lounge configurations. The height of the Piecera Lounge is the same as the seat height of the Poltrona Lounge or Banca Lounge. When put together, the Piecera 130 footrest can function as a sunbed as well.

Exceptional materials and a dedication to comfort

The high grade stainless steel frame, optional also available with an electro polished or powder coated finish, and Batyline mesh fabric seat give this designer footrest a timeless modern look.

The optional cushions for this luxury designer outdoor furniture provide comfort and style. The different styles of cushion options make it possible to create a patio lounging area with a unique appearance to fit your personal preferences. A tempting lounge set with big, comfortable cushions as an invitation for a cosy get-together, or a modern outdoor lounge setting which reminiscences to the Barcelona Chair by Mies van der Rohe, it will be a statement and a real eye-catcher on the patio or in the house.

FueraDentro outdoor design furniture is built to a very high quality from the highest quality materials. Designed for life long function, the materials exceed standards for durability and are suitable for all year round use, both indoors and out.





TABLA 150 & 200 LOUNGE LOW TABLE

Contemporary garden low table

The Lounge collection, designed by Hendrik Steenbakkers, contains two models of tables. Both the Tabla Lounge and the Mesita Lounge are available in several sizes, so in total one can choose between five different sized tables to complement the contemporary patio lounge set. All models of salon, coffee and side tables catch the eye by the minimalist rectangular shape of the stainless steel base which holds the table top in suspension, seemingly floating on air. Despite the robust frame, these modern designer low tables has a very spatial appearance.

The Tabla Lounge is available in two sizes, the Tabla 150 Lounge and the Tabla 200 Lounge. The stainless steel frame of these luxury lounge tables is available with a brushed, an electro polished or a powder coated finish. FueraDentro has extended this range of designer outdoor furniture with teak versions of these contemporary salon tables. For the table tops you can choose between a toughened matt glass, a ceramic or a teak version. The toughened matt glass and ceramic table tops are available in the colors black, white and cendre. Designed for life long function & outdoor chic,

Make a statement with your outdoor furniture designs

the materials exceed standards for durability and resistance to the outdoor elements. The Tabla Lounge is often used in combination with the Banca Lounge sofa, or as part of the Lounge Modular System. With the designer outdoor furniture of the Lounge Collection a stunning looking modern outdoor lounge area can be created which makes a statement of luxury in any garden, on any terrace or near the pool. The simple clean lines of this designer garden lounge furniture make this a timeless modern design.





MESITA 45, 78 & 91 LOUNGE LOW TABLE

Outdoor designer salon and side tables

The Lounge collection modern outdoor furniture range is pure lounge-style in a simple design, but it is more than style, it is a contemporary statement. The series of high quality modular patio lounge furniture consists of 3 seating modules, corresponding footstools, two sunbeds and several coffee and side tables. Mutual for this designer outdoor furnishings range are its clean lines combined with comfort.

The Mesita Lounge low tables, designed by Hendrik Steenbakkers, are the salon and side tables in this collection. The stainless steel frame, with an optional powder coated finish, holds the table top in suspension, which makes it look like the glass or ceramic table top is floating on air. For both the frame and the table top a teak version is available as well. The Mesita Lounge is available in the sizes 45, 78 and 91. All models of this deluxe low table are pure, minimalist and architectural in design.

The Mesita 45 Lounge is the smaller side table in this outdoor lounge furniture collection. The Mesita 78 Lounge is a coffee table which sides have the same dimensions as the sides of the Banca or Poltrona Lounge. This way it can be cornered between the two. The Mesita

91 Lounge is the bigger salon table and has the same width as the Poltrona Lounge chair. The toughened mat glass and ceramic table tops are available in the colors black, white and cendre. For the powder coated finish of the stainless steel frames you can choose between the colors black, white and cappuchino. The Tabla Lounge is a bigger and rectangular version coffee table in this patio furniture range.

Create your favorite arrangement in our comprehensive lounge collection

As of the Lounge Collection, the Mesita Lounge is often used in combination with the Banca Lounge sofa, Siesta Lounge sunbed or as part of the Cima Lounge modular system. This tempting modular lounge collection with optional big, comfortable cushions is an invitation for a cosy get-together and an eye-catcher in the garden or on the urban roof terrace. You can adjust the collection effortlessly to any style: a more exotic appearance with teak frames and cosy cushions or a more architectural look with stainless steel frames and cushions which reminiscence to the Barcelona Chair by Mies van der Ro







SIESTA LOUNGE SUN LOUNGER

The ultimate luxurious pool sun lounger

Decadent Siesta outdoor sunbed is very generously proportioned, making it one of the largest and most comfortable individual contemporary designer sun loungers available today. Comfort is further enhanced by the luxuriously deep cushions. Innovative features for this European design sunbed include a fully adjustable backrest, and carefully concealed castors, enabling the Siesta Lounge to be easily moved about. As part of the Lounge Collection modern outdoor living furniture range this sun lounger is a timeless statement of luxury and comfort.

The seats, made of Batyline mesh fabric, have a comfortable spring to it and are UV, mildew and stain resistant. The high grade reinforced stainless steel frame, optional available with an electro polished or powder coated finish, gives these designer garden sunbeds an ultra-modern look and are an ideal choice when looking to relax in luxury in your contemporary outdoor space or next to the pool. The Siesta Lounge sunbeds are often used as standalone objects or combined with the Mesita lounge side tables.

The sun lounger as extension of the outdoor lounge set

The optional cushions for the designer chairs and sofas are available in different styles which make it possible to adapt this designer lounge furniture to fit your personal preferences and give it an unique appearance. A tempting lounge chair with teak armrests and big, comfortable cushions or a modern stainless steel lounge chair which reminiscences to the Barcelona Chair by Mies van der Rohe, it will be a real eye-catcher on the patio or in the house. The cushions for this luxury outdoor furniture range are developed to provide superlative comfort and can be enjoyed all year round in many contemporary outdoor spaces.

The simple clean lines of the Lounge Collection make this a timeless modern design. The stainless steel elements to the furniture are optionally available in an electro polished finish. This provides optimum durability and resistance to even the harshest of marine environments.



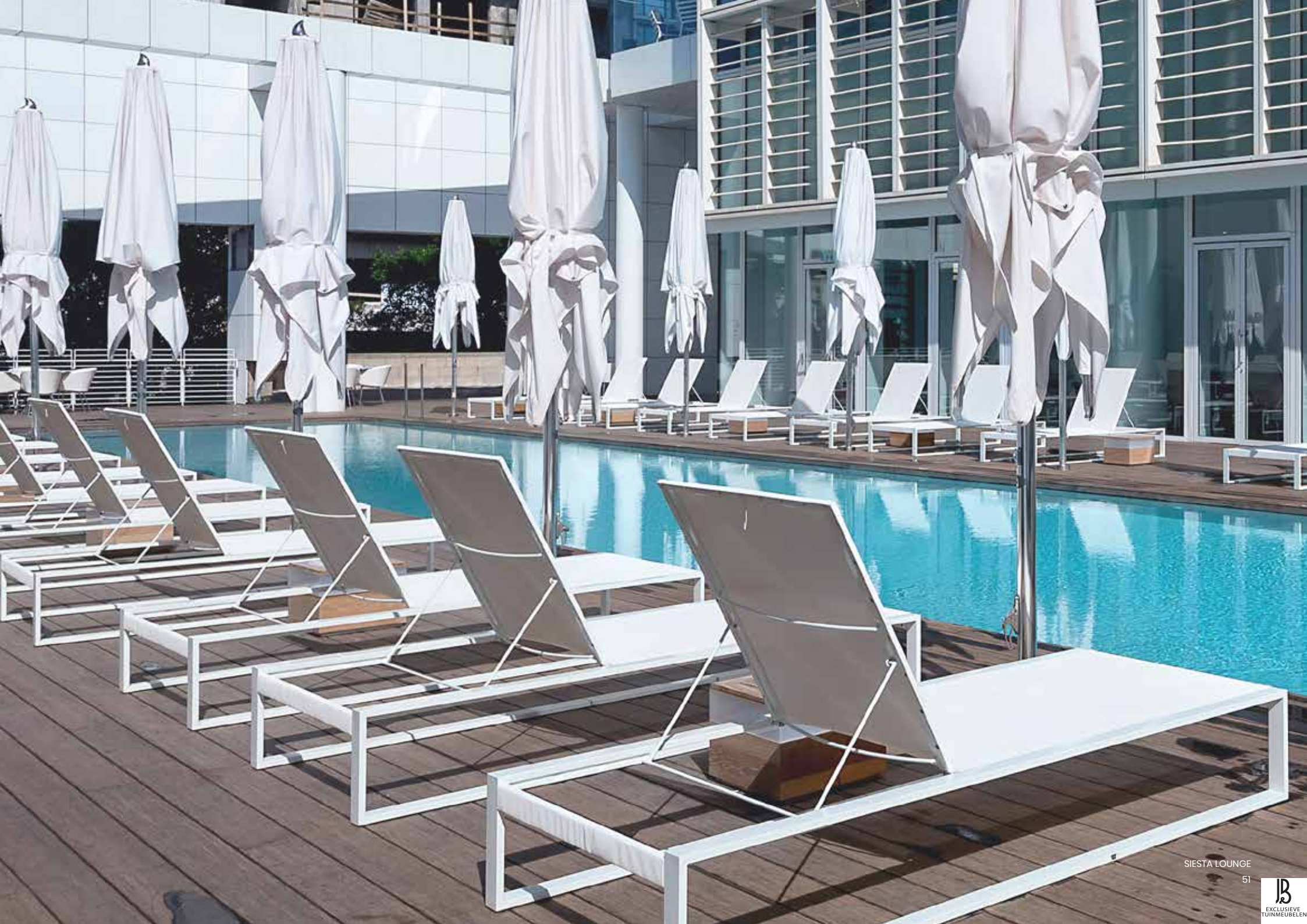

MODULAR LOUNGE SYSTEM LOUNGE SET

Contemporary modular outdoor lounge set

With the various pieces of the Lounge Collection Modular System one can assemble an outdoor lounge area to suit one's individual preferences. A small and cosy hardwood outdoor lounge set that perfectly complements the garden, a modern designer outdoor furnishing on the terrace to be enjoyed by family and friends or a large stylish contemporary lounge area at a hotel patio, everything is possible. An unlimited number of arrangements can be created, including L-shaped or U-shaped configurations.

To compose the outdoor lounge configuration to your liking there are three seat elements, a single seat, a double seat and a corner seat. All seat elements of this modular lounge range are ergonomically and slightly tilted to the back to enhance comfort and enjoyment. The several modular components of this designer outdoor furniture range are easy to install and are secured by a few bolts. This creates a solid constructed lounge configuration, without the components being able to glissade relative to each other. To personalize the lounge set one can choose for the frame elements between a stainless steel, a powder coated stainless steel and a teak version. The powder coated frames are available in the colors black, white and cappuccino.

Designer patio furniture that breathes comfort and luxury

The cushions for the Lounge collection, provide superlative comfort to this luxury outdoor furniture range and are available in

two very durable, hard wearing, UV resistant and waterproof materials, Tempotest fabric and Stamskin synthetic leather.

To adapt this modular lounge set better to suit your individual style, there are 'cozy' cushions available, which gives the designer patio lounge set a softer and warmer feel. These cosy cushions made of Tempotest fabric are standard available in four colours. This allows the outdoor set to be created to your own individual style and lets you optimize your personal visual and physical ideals.

Complementary outdoor lounge coffee and side tables

To complement the seating area five different sized lounge tables are available, with the same options for the frame elements. Table tops are available in toughened glass, ceramic or teak. The combination between the warm wood and the cool steel creates an attractive contrast, which lends the garden or terrace an contemporary, but very elegant ambiance. Another beautiful contrast is created if teak is combined with powder coated steel, or colored glass.

The Lounge Collection is available in the colors white, black and cendre (similar to taupe). In all settings the minimalist lines and slim design with extreme comfort remain preserved. In a corrosive environment the electro-polished version of the item's frame is recommended.





SHELL COLLECTION

The Shell Collection, has been specifically created for FueraDentro by the Dutch designer Jan des Bouvrie. This collection of retro design outdoor furniture comprises of chairs, easy chairs, sofas, luxurious sunbeds, as well as dining and low tables.

The most notable characteristics of the Shell Collection garden furniture range is the rounded shape of the shell-like cocoon seats, which brings a stunning and comforting sense of relaxation. The seats are made using a hand woven coaxial structured Batyline fiber that is tactile, functional, hard wearing and UV resistant. The frames are made of electro polished stainless steel and the tables have glass table tops with rounded corners. All materials are 100% recyclable. Its comfort as well as its sensual and elegant shapes create a unique object for using inside or outside.

Outdoor dining in bistro-style

The Shell patio dining sets will immediately create an intimate and natural atmosphere on any terrace or balcony, with design elements reminiscent of the 1950s and 1960s. The Shell Chair's has an unmatched comfort, its quality as well as its material character permit their use in both indoor and outdoor spaces. If this outdoor garden armchair is used in combination with the Shell Dining 100 outdoor designer table it creates a dining solution with a kind of bistro feeling. For this reason, its comfort and quality the Shell Chair is a popular patio dining chair for designer hotels and restaurants. The Shell Collection is

ideal for both large contract installations as well as small residential projects. The Shell Dining outdoor designer tables are available in several sizes. This is just perfection for stylishly adorning any terrace or veranda.

Mid-20th century cocooning

Be it for a nice conversation, reading a good book or simply relaxing the Shell Collection also offers an outdoor lounge solution. The Shell Sofa and Shell Easy Chair provide the same comfort and quality as the dining chairs in this modern outdoor living furniture series, but with a greater sense of cocooning to make the feeling of relaxation complete. The retro design lounge setting can be completed by the use of the outdoor coffee and side tables in this collection. The combination of subdued colors, shapes and water-resistant materials gives the arrangement a unique appearance on the patio or in the veranda.

The Shell Sunbed lounge, which provides superlative comfort, with rounded shapes and a design reminiscent of mid-20th century styles, is fully adjustable, from completely flat all the way through to an upright reading position. The large aluminum and rubber wheels match the color of the sunbed and enhance the great retro design. They also allow the lounge to be easily moved about.



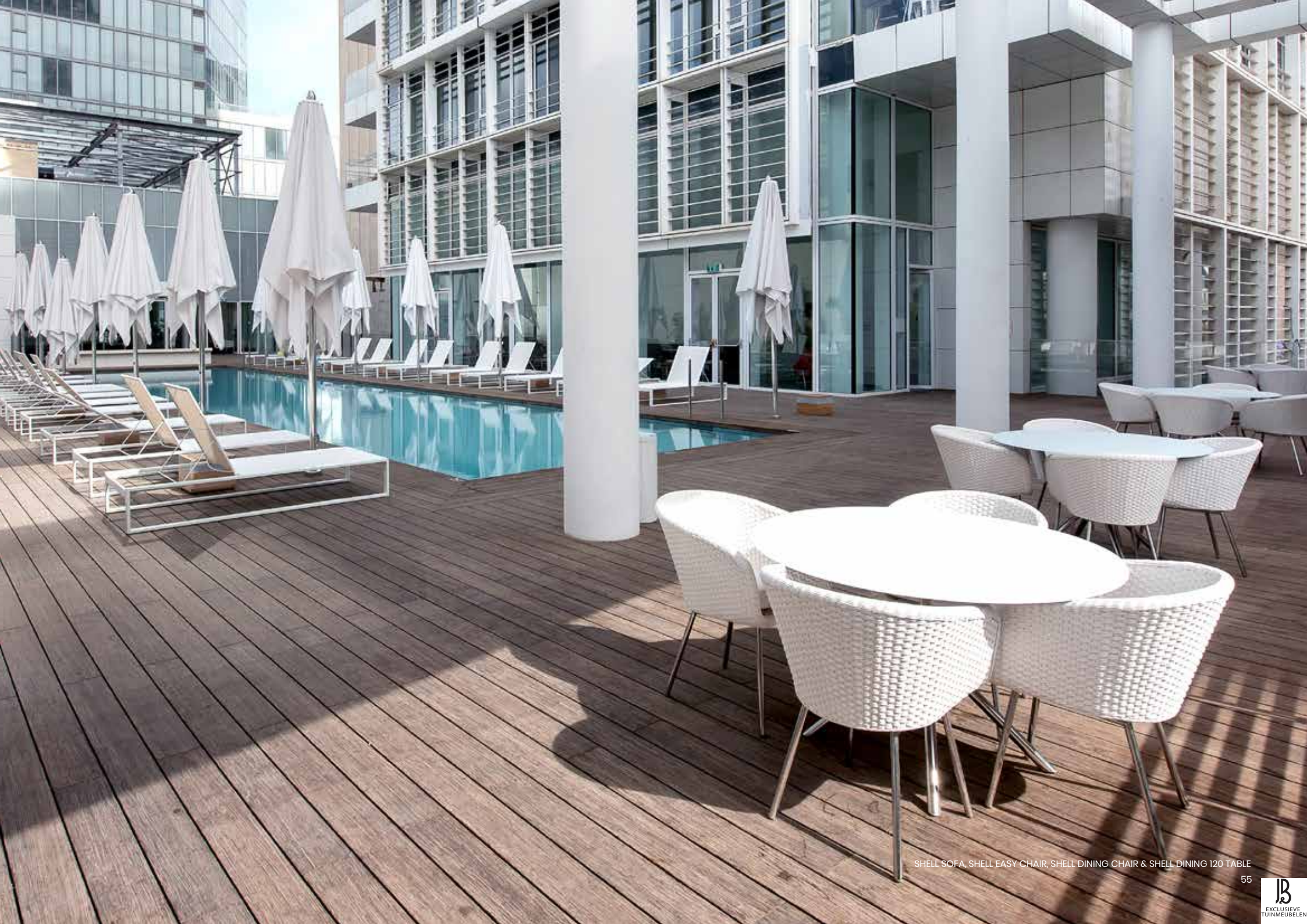

SHELL SOFA, SHELL EASY CHAIR, SHELL DINING CHAIR & SHELL DINING 120 TABLE

SHELL DINING CHAIR CHAIR

Contemporary retro design outdoor chair

The Shell Chair outdoor dining chair is characterized by the rounded 'Shell' shaped seats. Like a bucket seat this gives the seating elements an encapsulating, comforting and sheltered feel, whether you sit on the patio in the garden surrounding your own home or on a nice terrace at a restaurant viewing the ocean. Being part of the Shell collection, an exclusive outdoor furniture range designed by Dutch designer Jan des Bouvrie, these chairs are luxury modern European design with a retro feel. Exceptional durability and easy to maintain.

The hand woven coaxial structured seats of this patio and garden furniture collection are made using a Batyline fiber, a modern version of resin wicker with all the same properties, advantages and qualities of Batyline fabric, which is functional, hard wearing and UV resistant. The Batyline fiber from world leader Ferrari, guarantees optimal comfort, a lasting high tension and an excellent resistance to tearing and UV-rays. The frame of this contemporary designer outdoor chair is made of electro polished stainless steel. High grade stainless steel and Batyline fiber are modern

Outdoor dining solution with a bistro look

The combination of subdued colours (black, white and cendre), round shapes and water-resistant materials gives this range of modern outdoor furniture a unique appearance on the patio or in the veranda. If this garden dining armchair is used in combination with the Shell Dining 100 outdoor table it creates a bistro like dining solution. With a design reminiscent of mid-20th century styles it is a classic outdoor dining solution.

For its appearance, its comfort and quality the Shell Chair is a popular patio dining chair for designer hotels and restaurants. The cushions are available in a range of different colours allowing the user to further personalize the furniture. The Shell Collection patio furniture series is ideal for both large contract installations as well as small residential projects.





SHELL EASY CHAIR EASY CHAIR

Contemporary retro design garden lounge chair

The designer outdoor lounge chairs Shell Easy Chair, designed by Dutch designer Jan des Bouvrie, catch the eye because of the rounded shape of the shell-like cocoon seats, which gives the seating elements an encapsulating, comforting and sheltered feel. High grade stainless steel and Batyline fibre are modern materials with exceptional durability and this combination of materials makes the Shell patio and garden furniture collection ideal for outdoor use. The luxurious bucket seat is constructed in hand-woven mould resistant and UV resistant Batyline fibre, which is available in the colors black, white and cendre, and the high grade stainless steel frames come standard with an electro polished finish within the full Shell outdoor designer furniture range.

Are you looking for the ideal lounge set for your garden or terrace?

Whether you are looking for a couple of stylish lounge chairs for having a nice conversation or reading a good book or you are looking for a smaller but very comfortable lounge furnishing to simply relax, the Shell Collection designer garden furniture offers a modern outdoor lounge solution. Shell outdoor lounge furniture

is also very suitable to create multiple small lounge sets in, for example, public spaces or hotel pool areas. The Shell Sofa and Shell Easy Chair provide the same comfort and quality as the dining chairs in this modern outdoor furniture series, but with a greater sense of cocooning to make the feeling of relaxation complete. The combination of subdued colors, shapes and water-resistant materials give every setting an unique appearance on the patio, the roof terrace or in the veranda. The retro design lounge arrangement can be completed by the outdoor coffee and side tables in this collection.

The seats of the Shell Collection patio chairs are made using a hand woven coaxial structured Batyline fibre that is functional, hard wearing, UV resistant and low maintenance. The Batyline fibre, produced by world leader Ferrari, offers an optimal comfort, a lasting high tension and an excellent resistance to tearing and UV-rays. The stainless steel frames of all the exclusive patio furniture in the Shell Collection are made of electro polished stainless steel. All materials, Batyline, stainless steel and glass, are 100% recyclable.





SHELL EASY CHAIR, SHELL SALON & SHELL SOFA

SHELL SOFA SOFA

Exclusive, modern retro design outdoor lounge sofa

Because of their bulk, garden sofas generally are found in yards or on terraces of significant size. Often combined with a coffee table, they help create a living room-like atmosphere outdoors. For those who do not have the luxury of a large outdoor space, but would love to create a nice and comfortable lounge area, the luxury outdoor furniture of the Shell Collection offer the perfect solution.

The overall form of the sofa is an essential characteristic. In a small outdoor area or balcony a sofa of modest size with simple lines and a low back will be the best solution. The contemporary Shell Sofa is characterized by its clean, geometric lines and rounded shape of the hand-woven seating. Comfort is another important factor. Sink down into this high-quality garden furniture and feel all your tensions melt away. Unmatched comfort: beautiful and comfortable?

Part of the Shell collection, an exclusive outdoor furniture range designed by Dutch designer Jan des Bouvrie, these sofas have a retro style,

reminiscent of mid-20th century styles. The hand woven rounded seating elements gives a sense of shelter and comfort. Because of its stunning appearance and its unmatched comfort the Shell Sofa is perfect to be used as a standalone deluxe garden bench, but also to be combined with the easy chairs and low tables of this outdoor design furniture range and this way create a cosy lounge area that complements the surroundings.

The Shell Collection luxury outdoor patio furniture is ideal project furniture for hotels and restaurants. The bucket seats of the Shell Collection outdoor chairs are made of a hand woven coaxial structured Batyline fibre that is functional, hard wearing, UV resistant and low maintenance. The Batyline fibre, which is produced by world leader Ferrari, offers a lasting high tension and an optimal comfort, an excellent resistance to tearing and UV-rays. The stainless steel frames of all the Shell Collection luxury outdoor furniture have an electro-polished finish. All materials, Batyline, stainless steel and glass, are 100% recyclable.





SHELL ROCKING CHAIR CHAIR

Shell teak modern garden rocking chair

Outdoor rocking chair designed by Jan de Bouvrie. This designer outdoor rocking chair instantly conveys unique contemporary style and comfort – this is a chair you'll fight-over to stay seated in.

Shell Teak modern garden rocking chair can be used by itself or in conjunction with other components of Shell Teak outdoor lounge furniture.

The rocking chair is made in weather-proof garden furniture materials, Batyline weave from Serge Ferrari and high quality teak base. Ensuring it is ideal for high-end residential and hospitality projects year-round, whatever the weather, anywhere in the world.

This chair is available with a wide range of cushions. An all encompassing high cushion, supporting back and sides when seated, creating an uber comfortable experience. Also available is the standard cushion in two version, slim and normal thickness. This cushion can easily be combined with a Pil40 scatter cushion.

All of the above mentioned cushions can be made from the full range of Sunbrella® fabrics and of course any COM fabric.





SHELL ROCKING CHAIR.

SHELL SUNBED SUNBED

Contemporary retro design garden sun lounger

The Shell Sunbeds, designed by Dutch designer Jan des Bouvrie, mix luxury modern European design with a retro feel and are available in a range of colors. The first thing that catches the eye are the big wheels in the same colors as the hand woven seats. These high-end outdoor sunbeds look stunning near the pool or on the roof terrace.

This luxury outdoor daybed is made of exceptional high-quality materials; high grade stainless steel and Batyline fibre are modern materials with exceptional durability and are a classic option for relaxing and entertaining all year round in many outdoor spaces. This superlatively comfortable lounger, with rounded shapes and a design reminiscent of mid-20th century styles, is fully adjustable, from completely flat all the way through to an upright reading position. The large aluminium and rubber wheels match the color of the sunbed and enhance the great retro design. They also allow the lounger to be easily moved about.

Resilient to the harshest of marine environments

The frame of the Shell Sunbed is made of stainless steel with an electro polished finish, which we recommend for areas near the sea,

swimming pools or industrial districts, and the seat is constructed in hand-woven Batyline fibre, which is UV and mold resistant. The combination of these high quality materials makes the Shell collection ideal for outdoor use and resilient to even the harshest of marine environments. The inviting style of the Shell designer Sunbed can be further enhanced with coordinating cushions, available in a range of colors. The covers of these cushions are made of a solution dyed acrylic fabric, which is machine washable and very hard wearing, so you can relax in comfort.

Ideal retro furniture for smaller patio & outdoor areas

The Shell Collection is a series of retro outdoor furniture which is also very suitable for smaller patio and outdoor areas. This collection of retro design pool and garden furnishings comprises of chairs, easy chairs, sofas, luxurious sunbeds, as well as dining and coffee tables. All of the elements within the Shell designer patio furniture collection keep the sensual and elegant shapes that are so visually striking and ultimately comfortable.







SHELL DINING 100, 120 & 200 TABLE

Contemporary retro design garden dining table

The Shell Dining tables, designed by Dutch designer Jan des Bouvrie, are available in a rectangular, square format and round format. These modern design outdoor tables, with bases which are beautifully designed and carefully assembled and welded as one piece, are a work of art in themselves. The frame and legs of Shell modern garden dining tables are made in electro-polished high grade stainless steel, ensuring that they are resistant to the most demanding exterior conditions.

The table tops are made from toughened matt glass and have rounded corners. Curved, ergonomic edges not only look great, but also make the furniture a genuine pleasure to use year-round indoors and out. Due to only the highest quality materials being used, Shell designer garden tables require little maintenance other than an occasional wash with soap and water. The Shell Dining tables are most often combined with the Shell Chair.





SHELL SALON & SIDE TABLE SALON TABLE & SIDE TABLE

Contemporary retro design garden salon table

Shell modern design garden furniture, designed by Dutch designer Jan des Bouvrie, is a little gentler on the eye than some of our other modern ranges. The Shell Salon tables are most often combined with the Shell Easy Chair and Shell Sofa. This arrangement creates a subtle and very comfortable lounge area. Curved, ergonomic edges not only look great, but also make the furniture a genuine pleasure to use year-round indoors and out. The Shell collection is truly one of the most comfortable of all our collections.

The frame and legs of Shell modern garden Salon tables are made in electro-polished high grade stainless steel, ensuring that they are resistant to the most demanding exterior conditions. The electro-polished finish gives the steel a brilliant shine but also make it even more resilient to even the harshest of marine environments. The table tops are made from toughened matt glass with rounded corners. Due to only the highest quality materials being used, Shell designer garden tables require little maintenance other than an occasional wash with soap and water.

Contemporary retro design garden side table

The Shell Side is the little side table from the Shell Collection, designed by Dutch designer Jan des Bouvrie, with the circular table top. The Shell side table bases are beautifully designed and carefully assembled and welded as one piece; a work of art in themselves. The frame and legs of Shell modern garden Side tables are made in electro-polished high grade stainless steel, ensuring that they are resistant to the most demanding exterior conditions. The electro-polished finish gives the steel a brilliant shine but also make it even more resilient to even the harshest of marine environments.

The round glass table tops are made of toughened matt glass. In combination with the Shell Easy Chair, Shell Sofa or Shell Sunbed one creates an area for relaxation with a design reminiscent of mid 20th century styles. The Shell outdoor furniture range is ideal for the modern garden or modern hotel poolside, due to its resistance, low maintenance, and most importantly its stylish retro look and superlative comfort.







UW DEALER:



**J&B EXCLUSIEVE
TUINMEUBELN**

Ettensebaan 17A1
4812 XA Breda
www.jenb.nl
076-5961636

MACETERO 120, 80, 50 & CLI

70

MACETERO PLANTER

Contemporary design garden planter

Constructed in high grade stainless steel these planters are available in two different sizes and are an ideal contemporary accompaniment to garden, patio, terrace and poolside furniture and accessories. Attention to detail in the design and production of the Cima Macetero is outstanding; the adjustable stainless steel feet of this planter and the etched FueraDentro logo on the bottom, are subtle yet highly attractive features in themselves.

Designed by European designer Hendrik Steenbakkers, the Cima Collection is built to a very high quality from the highest quality materials. Designed for life long function, the materials exceed standards for durability.

The stainless steel elements to the furniture are optionally available in an electro polished finish. This provides optimum durability and resistance to even the harshest of marine environments.



FUERA
DENTRO

J&B
EXCLUSIEVE
TUINMEUBELN